

Specification

formulate	verify	approve

examine	confirmation	authorize

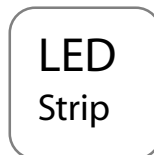
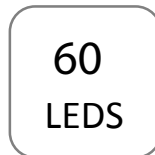

Item No : : YS-RN2835X 60

5000*8, 300 pieces of 2835 patch bare board non waterproof constant voltage 12V/24V flexible LED strip light

Picture :



Features :

- Using 2835 Lamp Beads, the light is uniform and energy saving
- Adopt front 10Z back 20Z FPC board, high heat dissipation, low light failure ;
- Good color consistency ;
- Use 3M double -side tape, easy to install ;
- Input DC voltage 12V / 24V optional ;
- UL & CE & RoHS approved.

Application :

Hotels, shopping malls, homes, cabinets, display racks, indirect lighting, dark trough lighting, contouring, decorative lighting , etc. .

Warranty :

3 years ;

Technical parameters :

Part No.	LED Color	CCT (K) Wavelength(nm)	CRI Ra	Color tolerance SDCM	Beam Angle (°)	Luminous Flux (lm/m)	Lighting effect (lm/W)	Input Voltage (VDC)	Current (mA)		Power (W)	
									1m	5m	1m	5m
YS-RN 2835 X60	Warm White	3000K	80	5	120	816 Lm	85	12	800	3167	9.6	38
YS-RN 2835 X60	Natural White	4000K	80	5	120	864 Lm	90	12	800	3167	9.6	38
YS-RN 2835 X60	Pure white	6500K	80	5	120	845 Lm	88	12	800	3167	9.6	38
YS-RN 2835 X60	Warm White	2400K	80	5	120	768 Lm	80	12	800	3167	9.6	38
YS-RN 2835 X60	Warm white	1900K	80	5	120	672 Lm	70	12	800	3167	9.6	38
YS-RN 2835 X60	Red	620-625nm	/	5	120	192lm	20	12	800	3167	9.6	38
YS-RN 2835 X60	Blue	460-465nm	/	5	120	144lm	15	12	800	3167	9.6	38
YS-RN 2835 X60	Green	520-525nm	/	5	120	672lm	70	12	800	3167	9.6	38

Other parameters :

Part No.	Protection grade ()	Working temperature ()	Standard length(m)	Maximum cascade length(m)	Number Of LED (pcs/m)	Light strip weight (kg/roll)
YS-RN 2835 X60	IP20	-25~+60	-25~+70	5	5	0.1

Remark :

- (1) Test environment temperature is 25±2 (normal temperature) ;
- (2) The above data is typical, the actual parameters of the product may differ from the typical data; the data is subject to change without notice
- (3) The above " -" indicates that the parameters of this product are not required at the moment ;
- (4) Power is greater than 15W/m, need to cooperate with the profile heat dissipation



YS-RN2835X60-12

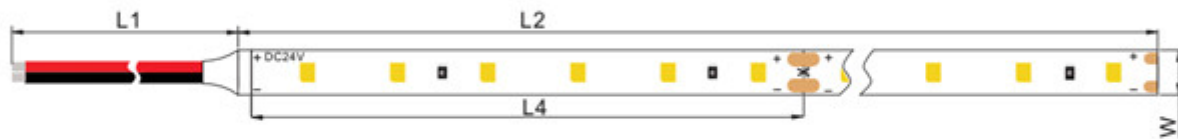

YS-RN2835X60-24



Model	L1	L2	L3	L4	W	H
YS-RN2835X60-12	200[7.87]	5000[196.8]	16.7[0.66]	50[1.97]	8.0[0.31]	1.4[0.05]
YS-RN2835X60-24	200[7.87]	5000[196.8]	16.7[0.66]	100[3.94]	8.0[0.31]	1.4[0.05]



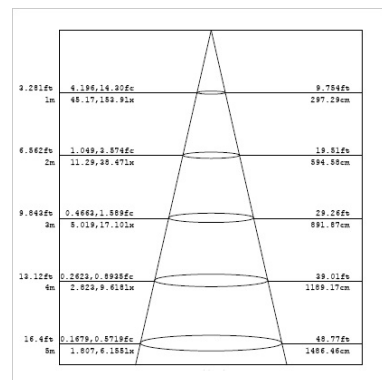
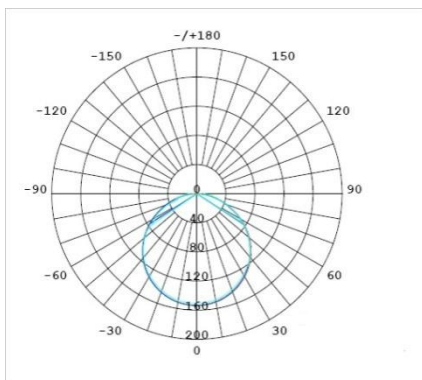

Protection level extension :



Packaging Information:

Part No.	Quantity per roll (m)	Quantity per box (m)	Total weight (Kg)	Outer box size (mm)		
				Length	width	height
YS-RN 2835	5	300	7.0	520	300	220
X60						

Protection level extension :

IP Rate	Picture	Dimension	Colors	Lumen output rate
IP20	 IP20 naked board	5000*8*1.5	2700K/3000K/4000K/ 5000K/6500K	100%
IP65	 IP65 Silicone spray	5000*8*1.7	2700K/3000K/4000K/ 5000K/6500K	98%
IP65	 IP65 Silicone tube	5000*10*4	2700K/3000K/4000K/ 5000K/6500K	95%
IP68	 IP68 Silicone intrusion	5000*10*4	2700K/3000K/4000K/ 5000K/6500K	90%

Packaging drawing :

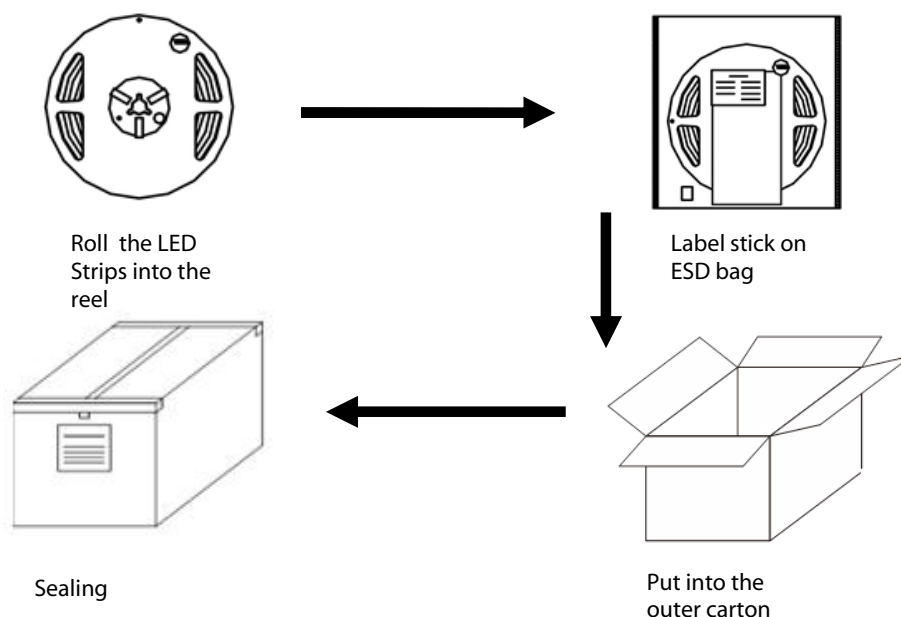

Red wire is "+", Black wire is "-"

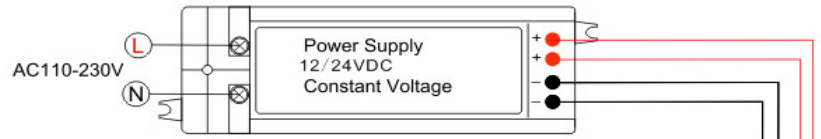

(Remark : The positive and negative wire need to be correctly connected to the positive and negative terminals of the power supply output.)

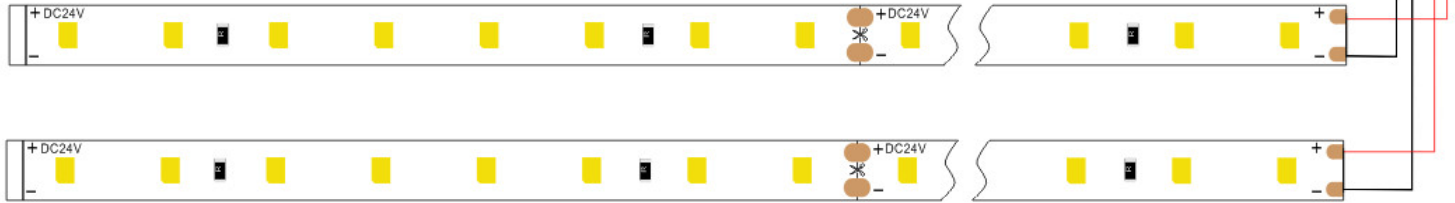

MAX : 5M

Installation step instructions and precautions :

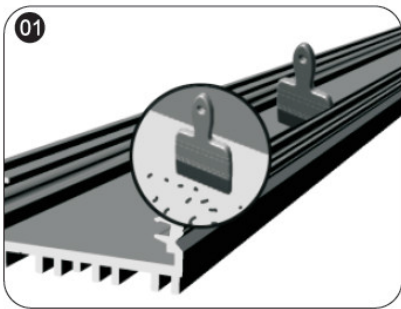

Clean up debris on the mounting surface to ensure surface cleaning

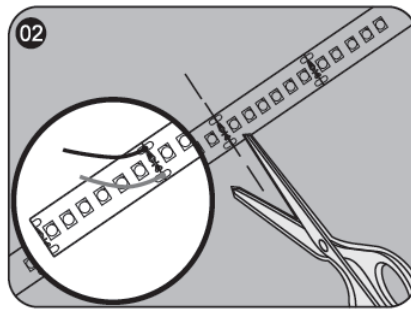

Measure the length of the strip to be installed, and cut the extra LED strip along the scissors marking line. If you need to increase the connecting wire, please weld it at the next scissors mark at the cut.

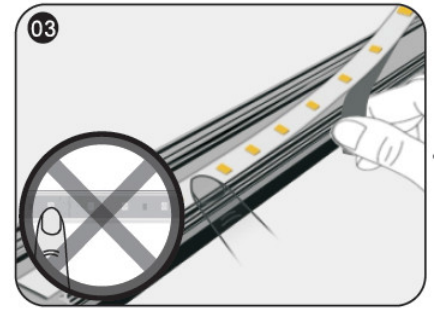

When attaching the led strip, be careful to peel while sticking. It is strictly forbidden to tear off all the release paper at once to prevent the led strip from sticking to each other.
Note: Do not press the lamp beads!



The position of the led where scissors are in contact with the bottom of the section need to isolate with sticker tape, so as to avoid short circuit.

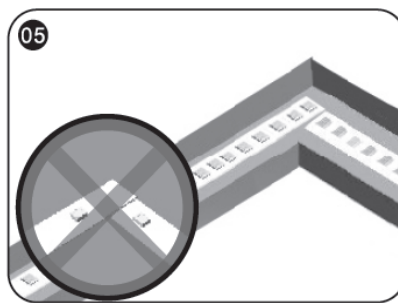

The light strip at the corner is installed as shown above
Note: Do not fold into a right angle
Direct bending on the surface of the profile is strictly prohibited



After the strip is installed, it is connected to the power output. Insulation, short-circuit protection and corrosion protection should be done at the terminals

02

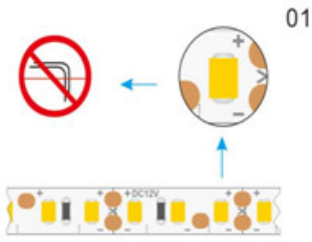

Don't bend the LED position



Don't twist the led strips

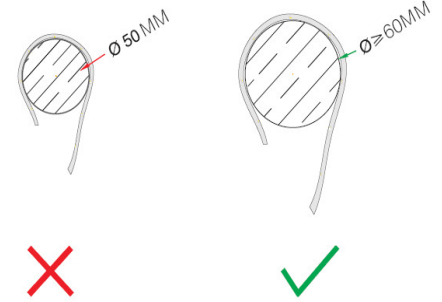

Don't wrap objects less than 5cm in diameter

Common faults of products and troubleshooting methods :

Fault phenomenon	Potential causes	Solution
All LEDs are off	1、 The power is off.	power transmission
	2、 Automatic protection of the power supply after the output of the switching power supply is open or shorted.	trouble shooting and recovering the power supply
	3、 LED Strips with power supply terminal polarity reverse	Check the wire connection to ensure correct connection of positive and negative wire
Some of the LEDs are off	1、 Part of the switching power supply is not powered	Check the power supply system and troubleshoot
	2、 Part of the electricity supply line error	
	3、 Partial led strips with reverse polarity connection	Correct connection
LED brightness is not the same or the brightness is not enough	1、 Power overload	Replace the power supply with a larger power according to the load
	2、 Switching power supply line or circuit loss is too large	Ensure that the operating voltage of the led strips is within $\pm 5\%$ of the rated voltage 1. Cut the length of the wire between the strip and the power cord or use wires with larger diameter; 2. Ensure that the number of each led strip is less than or equal to the maximum allowable cascade ;And make each strip with a similar connection.
	3、 Over connection of LED Strips	Adjust the number of strips for each power supply and to meet the maximum connection requirements for each power supply.
LED flashing	1、 Poor contact at the wiring point	Find out the bad points and troubleshoot
	2、 Switching power supply failure	Replace the switching power supply



Statement :

If the external cord of the product is damaged, it should be replaced by the manufacturer or its service agent or a similarly qualified person to avoid danger.

For the specific installation and precautions of the product, please refer to the product manual.

The data above in this specification is based on standard products. Actual shipments may be a little difference. Please refer to the actual product.

All product drawings in this specification are schematic diagrams, and actual shipments may be a little difference. Please refer to the actual product.

SHENZHEN YESUN LED Limited

Address : 3/F, Blog A3, Langxin industrial park, Shiyan Street, Bao'an dist., Shenzhen, Guangdong, China
Tel: 86 -755-29049310 Email: info@yesun-led.com
Web: www.yesun-led.com