

Z3U-V5F(160°)

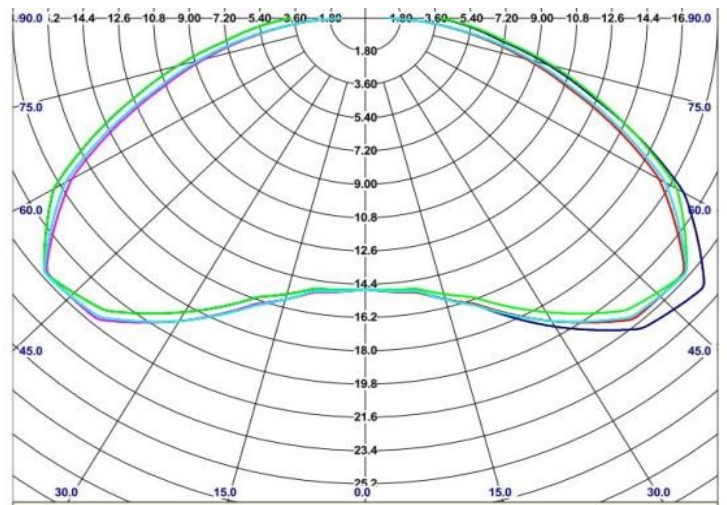

- LIGHT DISTRIBUTION (160°)



-FEATURES -

- **KOREA LED 5050 CHIP**
- **Wide beam Angle 160°**
- Long Life time (More than 50,000hrs at L70)
- Reserve voltage protection circuit
- Wide viewing angle for even light flux
- Capable of wet exposed applications with Durable weather protective molding
- Pre-applied adhesive tape and screw mounting bolt
- Safety Operation with DC 12V

- Design Patent -

US D858, 809S US D861, 922S

- CERTIFICATIONS-



- CE, UL(E349550), RoHs, KC, IP68, CB, BIS

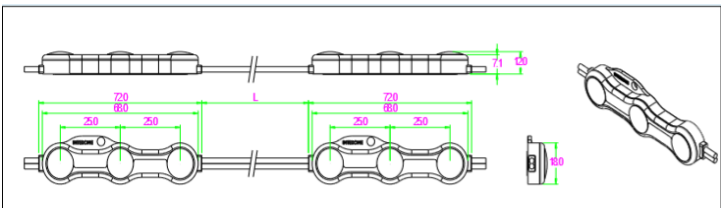

- PRODUCTION DEMENTION & PACKAGE -

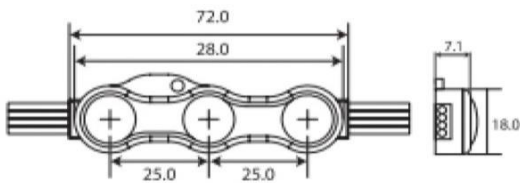

Dementions	Wire Length	Zipper polybag / Q'ty	Outer Box /Q'ty
72x18x7.1mm	95mm (3.74inch)	100pcs/bag	1,000pcs/box

- SPECIFICATION -

Operation Votage	Power Consumption	Current	Viewing Angle	WIRE & CASE	Operation Temperature	Storage Temperature	Water Proof
DC12V	0.72W	60mA	160°	AWG18 & ABS(100mm)	-20°C~60°C (-4°F~140°F)	-40°C~75°C (-40°F~167°F)	IP68